

TAL MENASHE



ABOUT HAREY ZAHAV

Harey Zahav is a pioneer real estate developer in Israel constructing private houses and garden apartments.

We are building family-oriented villages with strong sense of community.

2007
founded

3 000 units
future planning stages

25
projects

2 000 units
delivered to customers

6 000
housing units

1 000+ units
under construction



TAL MENASHE



150 FAMILIES LIVE
IN THIS COMMUNITY

We're Tal Menashe – a vibrant, religious community nestled in a natural woodland setting in northern Samaria. Life here unfolds at a distinct rhythm, harmonizing spiritual depth and Torah with the beauty of lush, green surroundings.

In the morning, you'll wake up to a forest view outside your window, with Harish or Route 6 just a 10-minute drive away and no checkpoints in between. In the evening, you'll return to pastoral quiet and a warm, supportive community.

This is why we're the perfect alternative for those seeking a rich Torah-centered life in a central location – and at affordable prices.



LOCATION

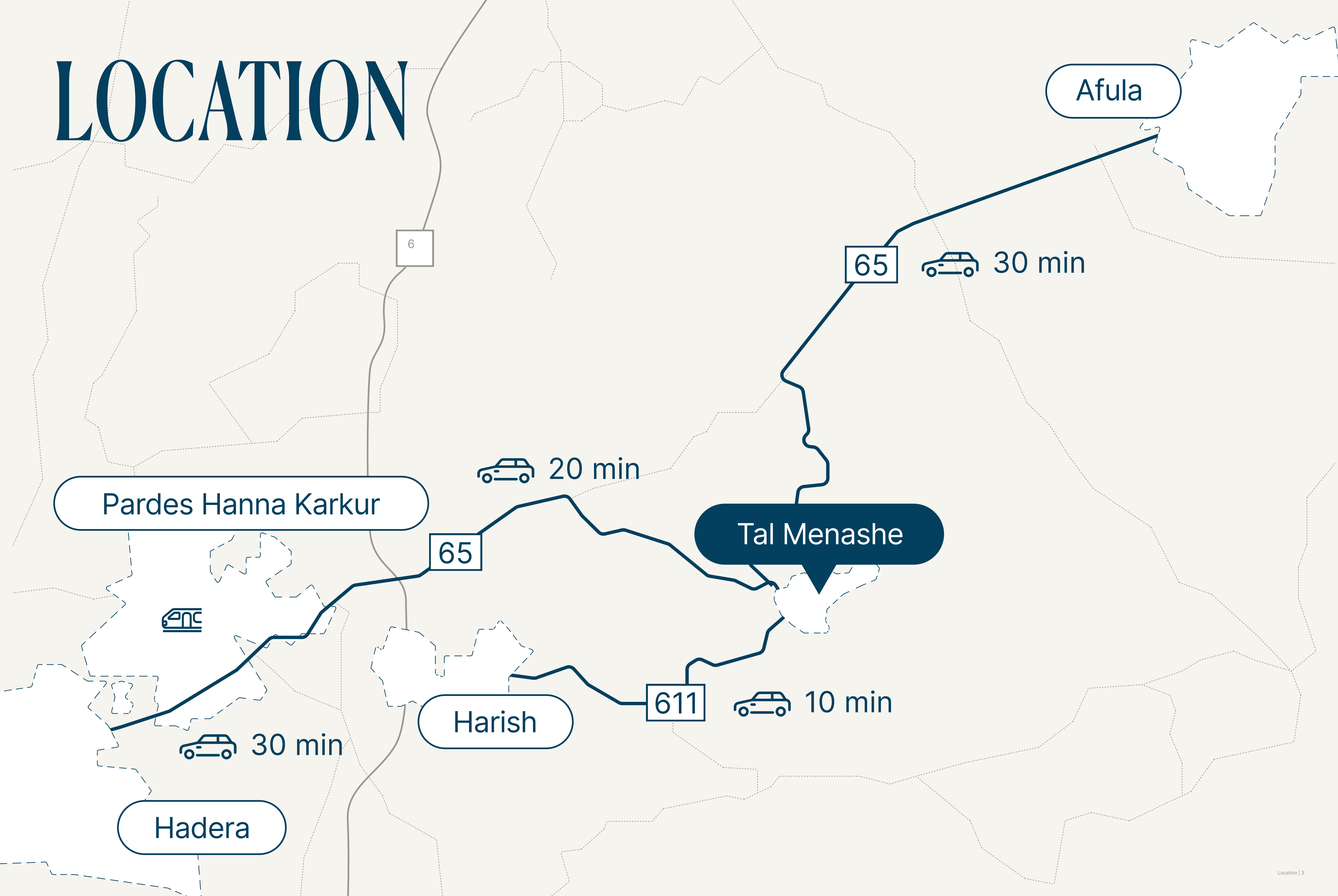

INFRASTRUCTURE

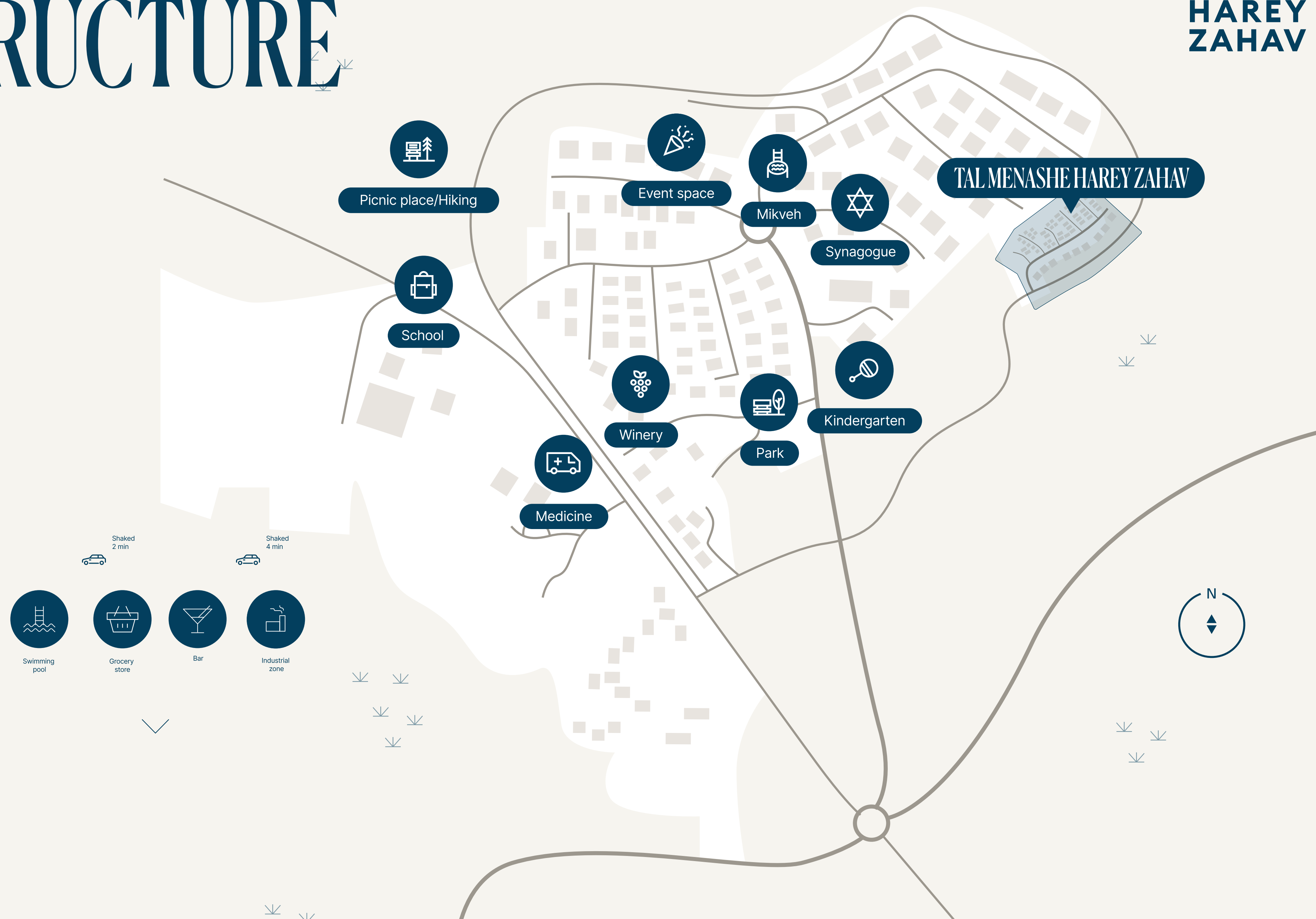

LIFESTYLE

In Tal Menashe, there are educational institutions for early childhood, kindergartens, and a regional religious elementary school named "Talalei Orot," which has about 200 students. The school includes a 'Talmudic Garden,' where students participate in agricultural work, an active petting zoo, a computer room, and more. For secondary education, the girls attend an Ulpana in Pardes Hanna, and the boys attend a high school yeshiva in Harish, Yeshivat Bnei Akiva Kfar Haroeh, among others.

At the heart of the community is a spacious synagogue, where Torah classes are held almost around the clock. During the summer, you can also enjoy the pool in the nearby Shaked settlement, with separate hours.

Tourism enthusiasts will find nearby the "Children's Legends Forest," the Tal Menashe Winery, and the "Bell and Pomegranate" Jewish art visitor center, all right here. Additional services can be found just a 10-minute drive away in the city of Harish.



NATURE & PARKS

Living in Tal Menashe feels like stepping into a postcard. Our community is nestled within a natural reserve, offering breathtaking views of the woodland landscape all year round. Our commitment to nature includes the establishment of Bereshit Orchard Park, where plants inspired by ancient sources flourish alongside a picnic area, a scenic viewpoint, and a 500-meter nature trail through the woodland.

Our newest project overlooks this enchanting green expanse, a view that's protected from future construction.



COMMUNITY

Our community of 150 families is a tapestry of diverse backgrounds. Here, leading tech engineers and senior executives live side by side with educators and spiritual leaders, all united by a shared vision of a full religious life. We aim to build a community founded on quality human connections.

Here, status is not measured by the size of your house or the brand of your car, but by commitment to shared values and a deep connection to community. Our social life is lively and meaningful, offering a range of activities for all ages, grounded in simplicity and purpose without the need to show off material wealth.



RELIGIOUS COMMUNITY

Stage 1

Stage 2A

Stage 2B

Stage 3

TALMENASHE

By Harey Zahav

PROJECT PLAN

91 HOUSING UNITS

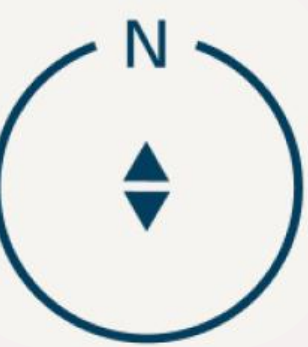

SEMI ATTACHED HOUSES

1 FLOOR



SEMI ATTACHED HOUSE

Model: Nitsan



GARDEN

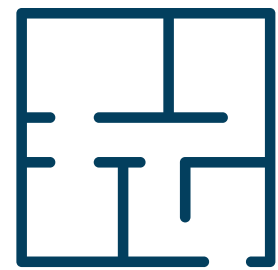

3 BEDROOMS

133 m² 1,431.6 ft²



SEMI ATTACHED HOUSE

HAREY
ZAHAV

2 FLOORS



SEMI ATTACHED HOUSE

Model: Gal Extended



GARDEN



BALCONY

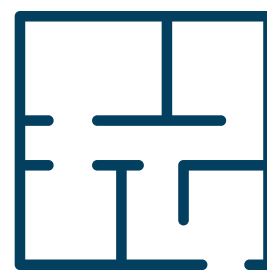

6 BEDROOMS



Floor 1

Floor 2

209 m² 2,249.7 ft²

GARDEN APARTMENT



GARDEN APARTMENT

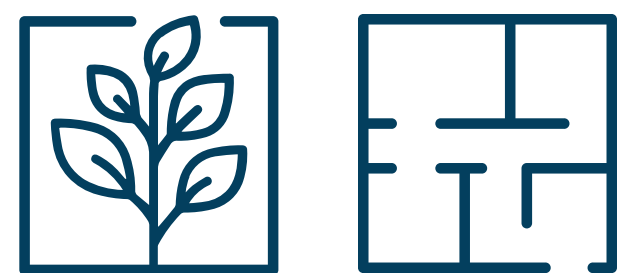

GARDEN

5 BEDROOMS

151 m² 1,625.4 ft²



GARDEN APARTMENT



GARDEN APARTMENT

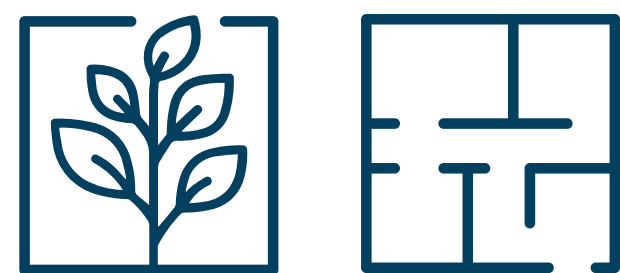

GARDEN

4 BEDROOMS

126 m² 1,356.3 ft²





PRIVATE HOUSES

PRIVATE HOUSE

Model: Peleg



GARDEN

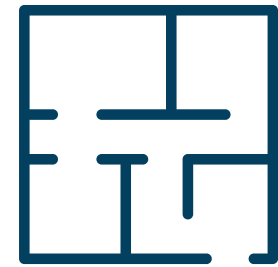

4 BEDROOMS

156 m² 1,679.2 ft²

PRIVATE HOUSE

Model: Peleg Extended



GARDEN

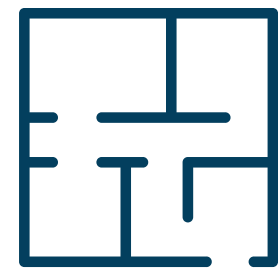

7 BEDROOMS

254 m² 2,734 ft²



INTERIORS

HAREY
ZAHAV



INTERIORS



INTERIORS



SPEAK WITH A REAL ESTATE ADVISOR

Shlomo Ben David

Tel (US) [+1-646-809-4577](tel:+16468094577)

Tel (WhatsApp) [+972-534-648451](tel:+972534648451)

Email ShlomoB@hzahav.co.il

Website hzahav.co.il



HAREY
ZAHAV

