



HAREY
ZAHAV

PNEI KEDEM

ABOUT HAREY ZAHAV

Harey Zahav is a pioneer real estate developer in Israel constructing private houses and garden apartments.

2007

founded

3000

units
future planning stages

25

projects

2000

units
delivered to customers

6000

housing units

1000+

units
under construction



PNEI KEDEM

Welcome to Pnei Kedem, a community perched at one of the highest points in Gush Etzion — 900 meters above sea level. We're one of the last places in Gush Etzion where you can still find a private home at an affordable price.

Our residents represent the broad spectrum of the national-religious community, united by a love for nature and communal living.

Over the years, a special, quality population (don't take our word for it — this is what others say about us) has settled here, leading unique initiatives in ecology and sustainability, including recycling, green energy, and private ventures like wineries, natural cosmetics, and essential oils.

LOCATION



Eastern Gush Etzion, Judean Hills –
20 min from Metzad



~ 30 min to Jerusalem (to Talpiot)
~ 1.5 hrs to Tel Aviv
~ 15 min to Efrat



Over 900 meters above sea level
with panoramic desert and mountain views



Part of Israel's Negev & Judean Desert expansion
vision, with new housing plans underway

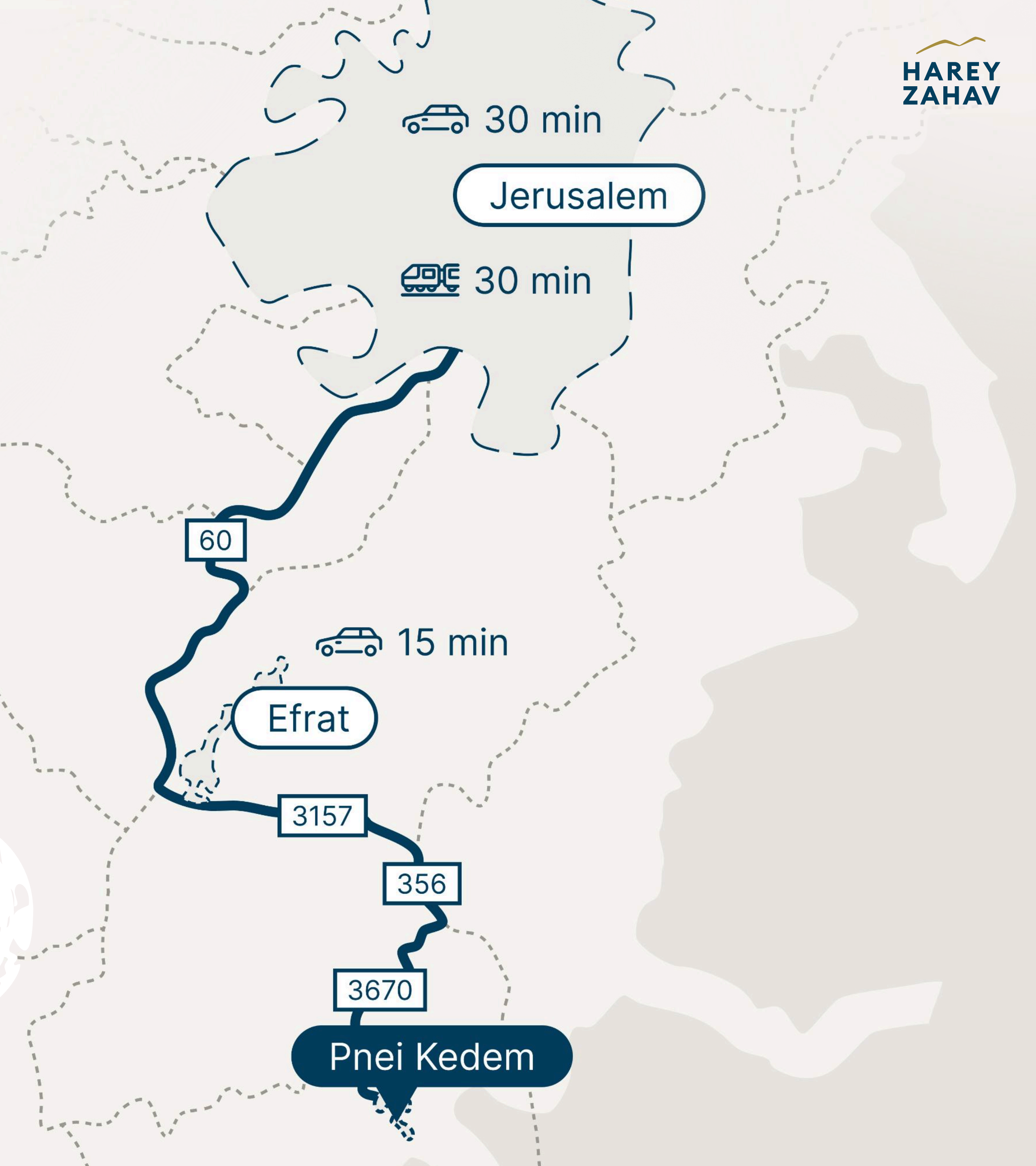

ABOUT GUSH ETZION

Gush Etzion is one of Israel's most vibrant regions, known for its natural beauty, rich history, and strong communities.

Lifestyle

Wineries, hiking trails, nature reserves, and family-oriented communities.

Education & Services

Wineries, hiking trails, nature reserves, and family-oriented communities.

Heritage

Ancient Jewish presence dating back to the time of the Bible, renewed in the 1940s and again after 1967.

Location

South of Jerusalem, at the crossroads of the Judean Hills.

Accessibility

Only 30 minutes to Jerusalem, with expanding road networks.

Major Communities

Efrat, Alon Shvut, Kfar Etzion, Neve Daniel, Elazar, Bat Ayin, Tekoa, Rosh Tzurim, Migdal Oz, and Metzad (Asfar).



THE SURROUNDING ESSENTIALS

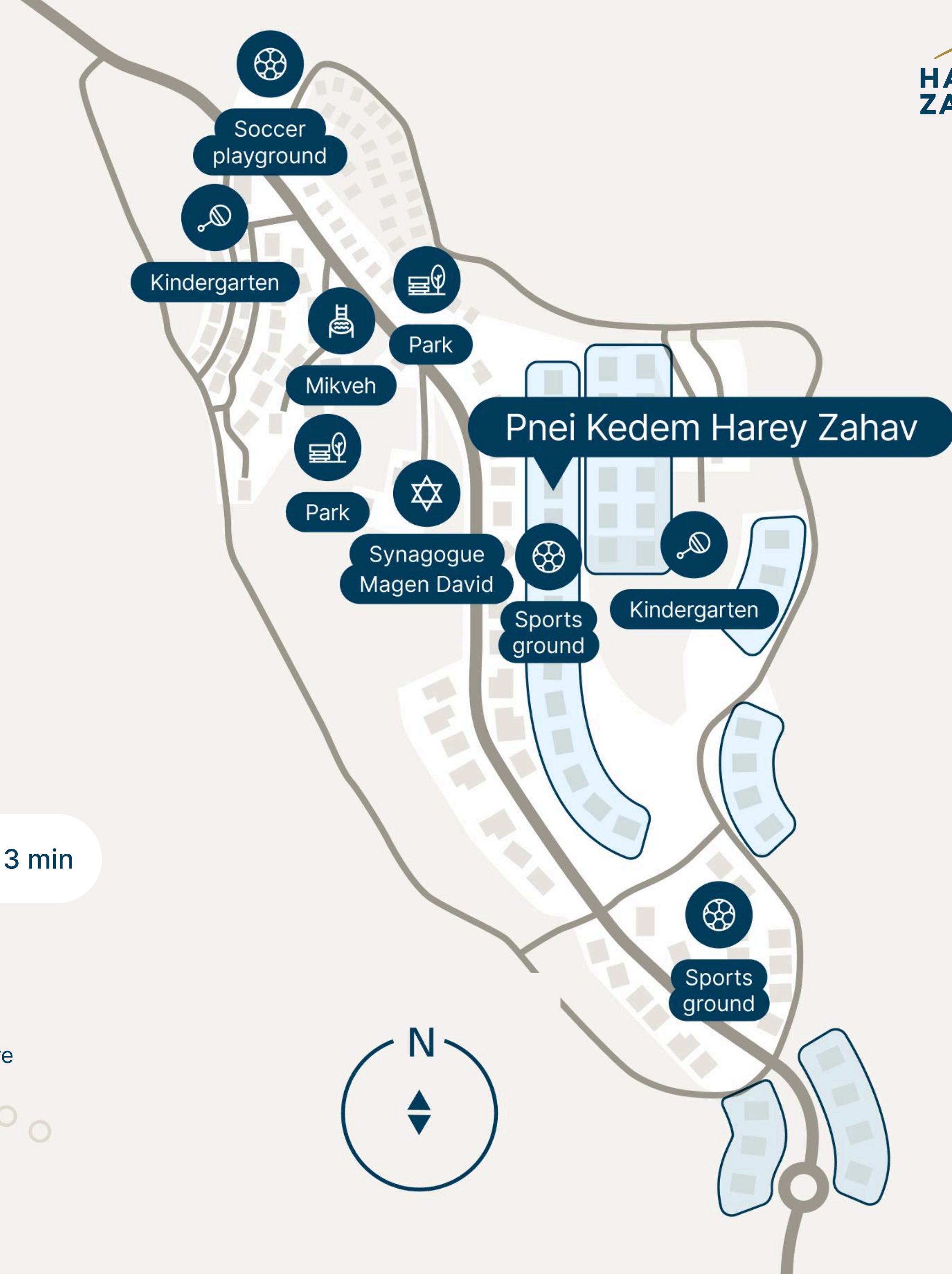

 Alon Shvut | 20 min

 Efrat | 15 min

 Metzad | 3 min



School



Yeshiva



Cafe



School

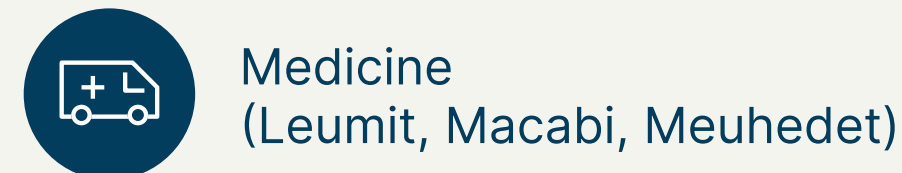

Medicine
(Leumit, Macabi, Meuhedet)



Grocery Store



School



Restaurant

EDUCATION AND DAILY LIFE

Education

In Pnei Kedem, located in Gush Etzion, every child finds their own path to growth. Whether at Gvaot School, where students learn in nature under the open sky.

At Bereshit Integrated School, which demonstrates how the inclusion of children with special needs enriches everyone. Or at HaGiva HaTzeuba Religious School, which combines Torah education with high-level academics. As they continue their education, girls can choose between the excellent ulpanot.

Or Torah Oriah and Neveh Hanna, while boys study at the prestigious yeshivas Har Etzion, Mekor Chaim, and Neveh Shmuel. The community's prime location, just a short drive from Jerusalem, also provides students access to the city's vast educational opportunities.

Daily life

In Pnei Kedem, you'll find everything you need for a good life, with plenty of added value: two synagogues (in case you're running late for one), mikvehs for men and women, kindergartens, a Bnei Akiva branch, and a library. Our committees for community, culture, and youth are especially active. We're 20 minutes from Herzog College, 30 minutes from Hebrew University, and just a short drive from Gush Etzion's commercial center, where you'll find clinics, stores, and everything in between. And when the craving for pizza hits, there's an excellent spot just two minutes away in Meitzad.

Pnei Kedem is also known for the annual Kite Festival, which draws thousands to the area. In 2020, we planted a community orchard, and in 2021, we inaugurated the Micha'el Lookout.

Our residents aren't just professionals — they're farmers at heart. With 50 acres of olive groves and vineyards, we've embraced agriculture. In 2018, we established a sheep farm operated with the help of local youth volunteers.



MORE THAN A NEIGHBORHOOD

Religious community

Pnei Kedem community is a winning mix of around 70 families and 30 students from the Kedma student village.

Together, we embody the best of religious Zionism, infused with youthful energy and a pioneering spirit.

The student residents are an integral part of our community, volunteering and running programs for children.



INTERNATIONAL COMMUNITY

Pnei Kedem – An International Community Founded by pioneers from Australia, England, and the USA, Pnei Kedem has grown into a truly global neighborhood. Today, families from around the world call it home — including residents from France, Russia, and beyond. The student residents are an integral part of our community, volunteering and running programs for children.

It's a unique place where you can integrate into Israeli life, while still feeling comfortable speaking your native language and connecting with people who share your background.

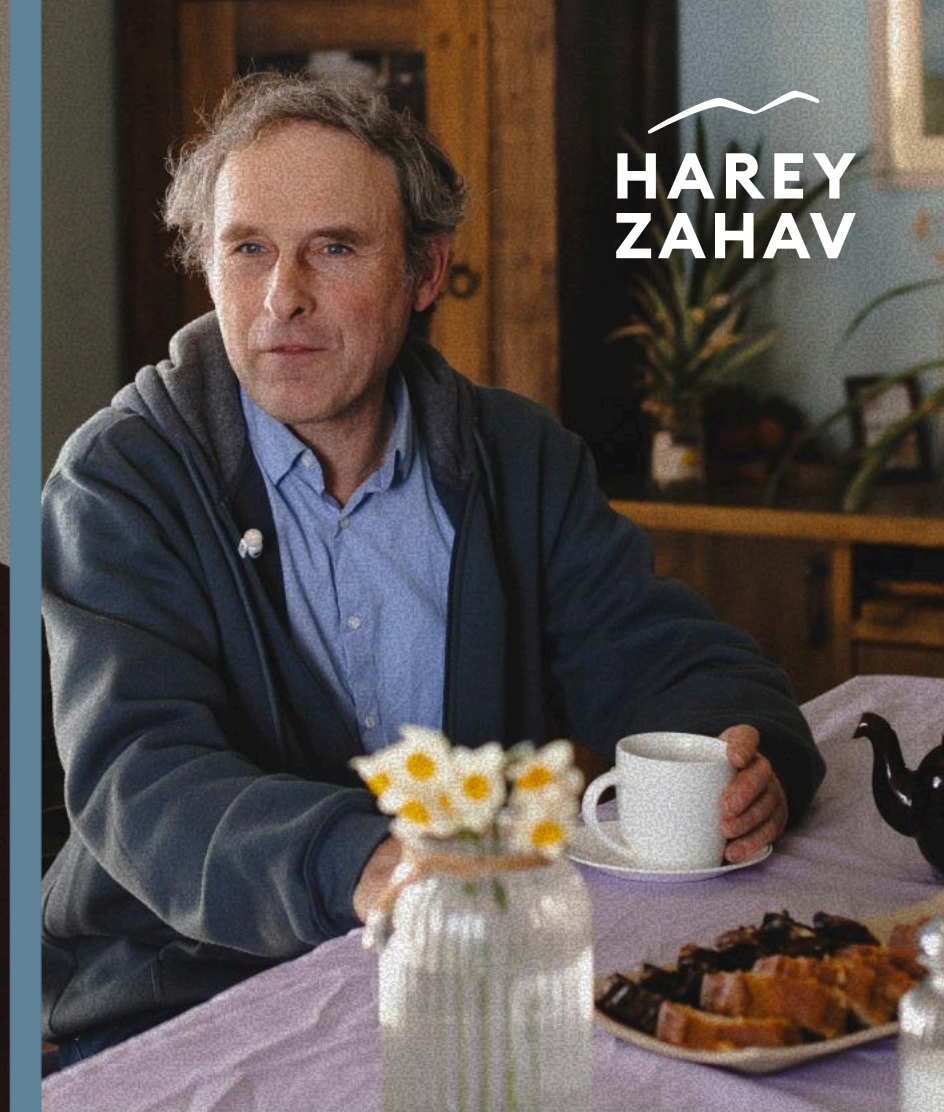



SURROUNDED BY NATURE

If you've ever wondered what Israel looks like in 4K,
our landscape is the answer.

Below the community winds the Arugot Stream,
and before us is a dramatic 1,300-meter drop down
to the Dead Sea (and no, you can't paraglide down).

Our eastward-facing location inspired our name:

Pnei Kedem, «Facing East»

JANUARY
2026

JANUARY
2026



PNEI KEDEM

Harey Zahav

PROJECT MAP

67 HOUSING UNITS PLANNED

2028 DELIVERY DATE

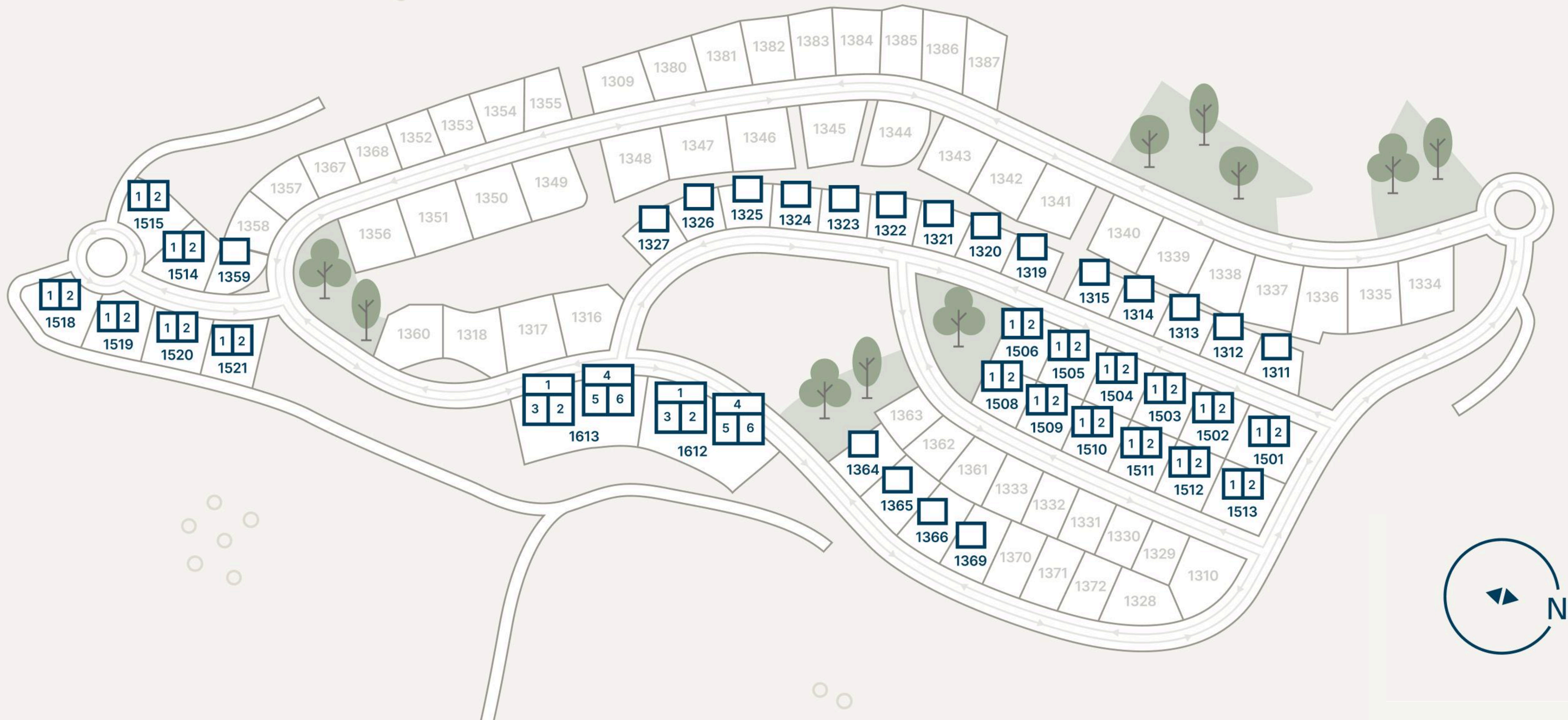



PRIVATE HOUSE



SEMI ATTACHED HOUSE

SEMI ATTACHED HOUSE



Garden



3 bedrooms

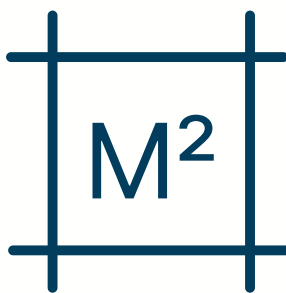

122 m²

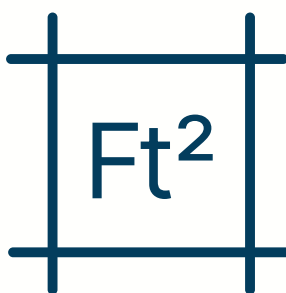

1,237.9 ft²

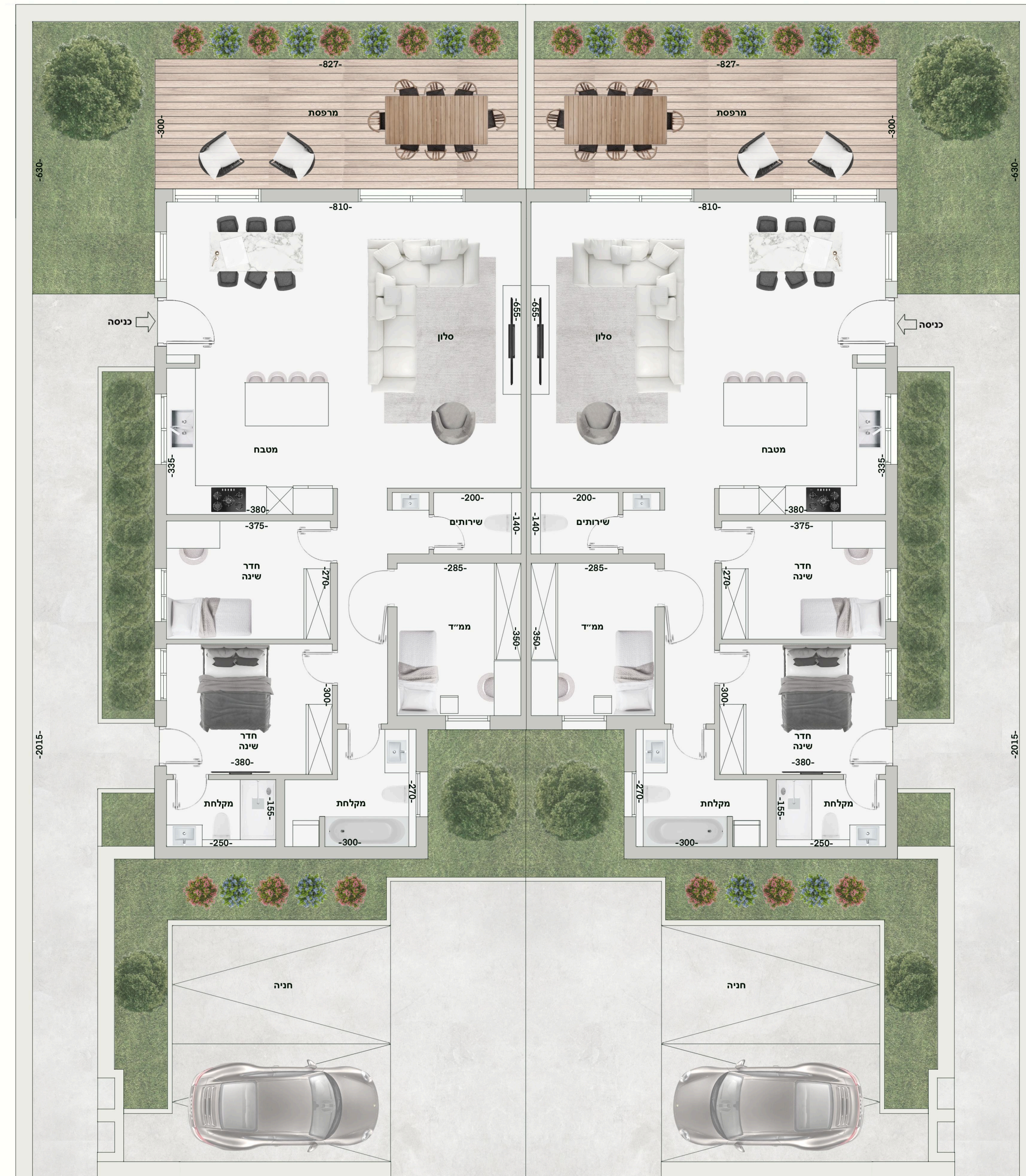

SPECIFICATIONS & FINISHES:



Kitchen

- High-quality kitchen including lower cabinets and a built-in unit, with soft-close mechanisms and preparation for a dishwasher
- Caesarstone countertop in a selection of colors
- Power outlet for an induction cooktop
- Option for a full kitchen credit
- Gas point for a cooktop
- Flush-mounted sink
- Pull-out faucet

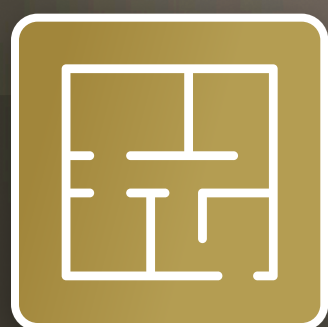

Planning

- Unique and carefully designed architectural planning
- master bedroom suite with an en-suite bathroom



Air conditioning

- Preparation for air-conditioning units in the living room and bedrooms
- “Omer” ventilation unit installed in the safe room (Mamad)



Doors

- High-quality interior doors in a selection of designs
- Entrance door by rav bariach or equivalent



Electricity & Communications

- Three-phase electrical system
- TV and telephone points in all bedrooms and the living room



SPECIFICATIONS & FINISHES:



Bathrooms

- Wall-hung toilets with concealed flush tanks
- Bathroom cabinet with integrated sink in the bathrooms
- Walk-in shower areas
- 4-way concealed mixer (interfutz)
- Acrylic bathtub
- Preparation for a heating unit in the bathrooms



Aluminum & Windows

- Electric rolling shutters in the main living area and bedrooms
- Window screens



Water Heating System

- Solar/electric water heating system



Flooring

- 80×80 cm flooring in the livingroom and bedrooms, in a selection of designs
- flooring and wall tiling in bathrooms, in a selection of designs



Balcony & Garden

- Tiled surface in the garden
- Lighting points/electrical outlets/water points
- Gas point in the garden/balcony



Parking

- Two private parking spaces
- Preparation for an electric vehicle charging station

INVESTMENT POTENTIAL OF JUDEA SAMARIA

WHY IT'S A SMART, STRATEGIC MOVE?

Affordable Entry, Strong Upside

Homes here cost 3–4x less than in Jerusalem or Tel Aviv, offering rare opportunities to buy full houses with gardens and benefit from long-term appreciation.

Fast-Growing Communities

Population growth in Judea and Samaria outpaces the national average, fueled by young families, new olim, and professionals seeking space and quality of life.

Close to Israel's Centers

Many communities are just 20–40 minutes from Jerusalem and Tel Aviv, with road upgrades and infrastructure projects improving access every year.

Rental & Second- Home Potential

Demand is strong for long-term rentals and Aliyah-ready homes. Larger houses in scenic areas also perform well in the short-term rental market.

Zionist ROI

Investing here means more than financial ROI — it's a chance to support Israel's growing heartland while building a lasting legacy.

COMMON QUESTIONS *about Buying* IN JUDEA & SAMARIA

«Is it only for very religious families?»

Not at all. Some communities are strongly religious, but many are mixed or diverse, with room for families of different backgrounds and lifestyles.

«Is it safe?»

Yes. Communities are well-protected with 24/7 security, gated entrances, and local patrols coordinated with the IDF. Families live here with peace of mind, children play outside freely, and Anglo immigrants continue to choose these areas because of the secure and welcoming atmosphere.

«It feels far from Jerusalem or Tel Aviv»

Many communities are just 20-40 minutes from Jerusalem, and under an hour from Tel Aviv. New highways and tunnels make access faster every year.

«Are services and schools available?»

Gush Etzion, Binyamin, and Samaria offer excellent schools, clinics, synagogues, and cultural centers — often on par with or better than central Israel.

SPEAK WITH A REAL ESTATE ADVISOR

Shlomo Ben David

Tel (US) [+1-646-809-4577](tel:+16468094577)

Tel (WhatsApp) [+972-534-648451](tel:+972534648451)

Email ShlomoB@hzahav.co.il

Website hzahav.co.il

